

CAUTION : Read instructions thoroughly and completely prior to beginning installation.

Installation instructions for in air bushing - Type C interface



400A-24B

630 A - Up to 24 kV

For indoor applications



FOR INFORMATION ONLY Please always use the instructions supplied in the kit

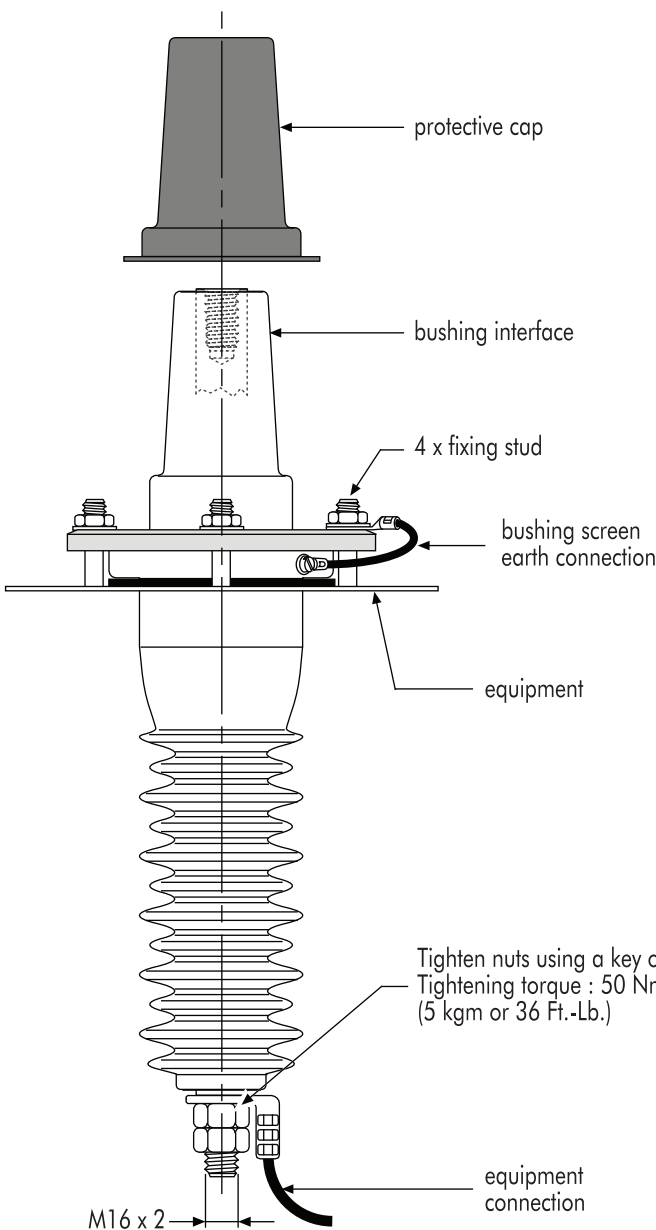

IMPORTANT NOTES :

- EUROMOLD bushings are supplied with protective caps over the mating interface offering protection against mechanical damage and the ingress of any contaminant. Under no circumstances should this shipping cap be considered as an electrical dead-ending device.
- EUROMOLD bushings should never be energised in isolation neither should they be disconnected whilst energised. They should always be connected to one of the recommended mating parts or the electrical dead-ending device : K400DR-B or K400DR-B/G.
- Do not paint the interface.

Tighten nuts using a key of 24 mm.
Tightening torque : 50 Nm
(5 kgm or 36 Ft.-Lb.)

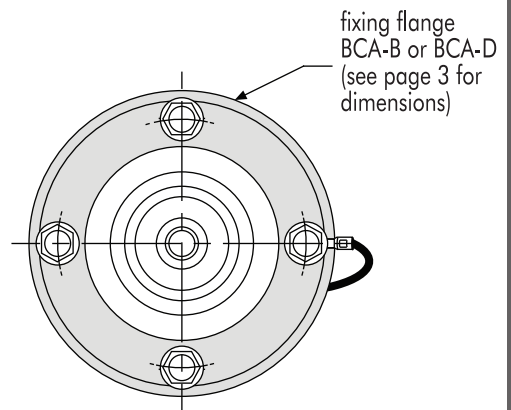

Euromold
a Nexans company

This product should be installed only by competent personnel trained in good safety practices involving high voltage electrical equipment. These instructions are not intended as a substitute for adequate training or experience in such safety practices. These instructions do not attempt to provide for every possible contingency. Failure to follow these instructions could result in damage to the product and serious or fatal injury. **IMPORTANT :** Cable and associated apparatus must be de-energised, locked out, and tagged prior to product installation.

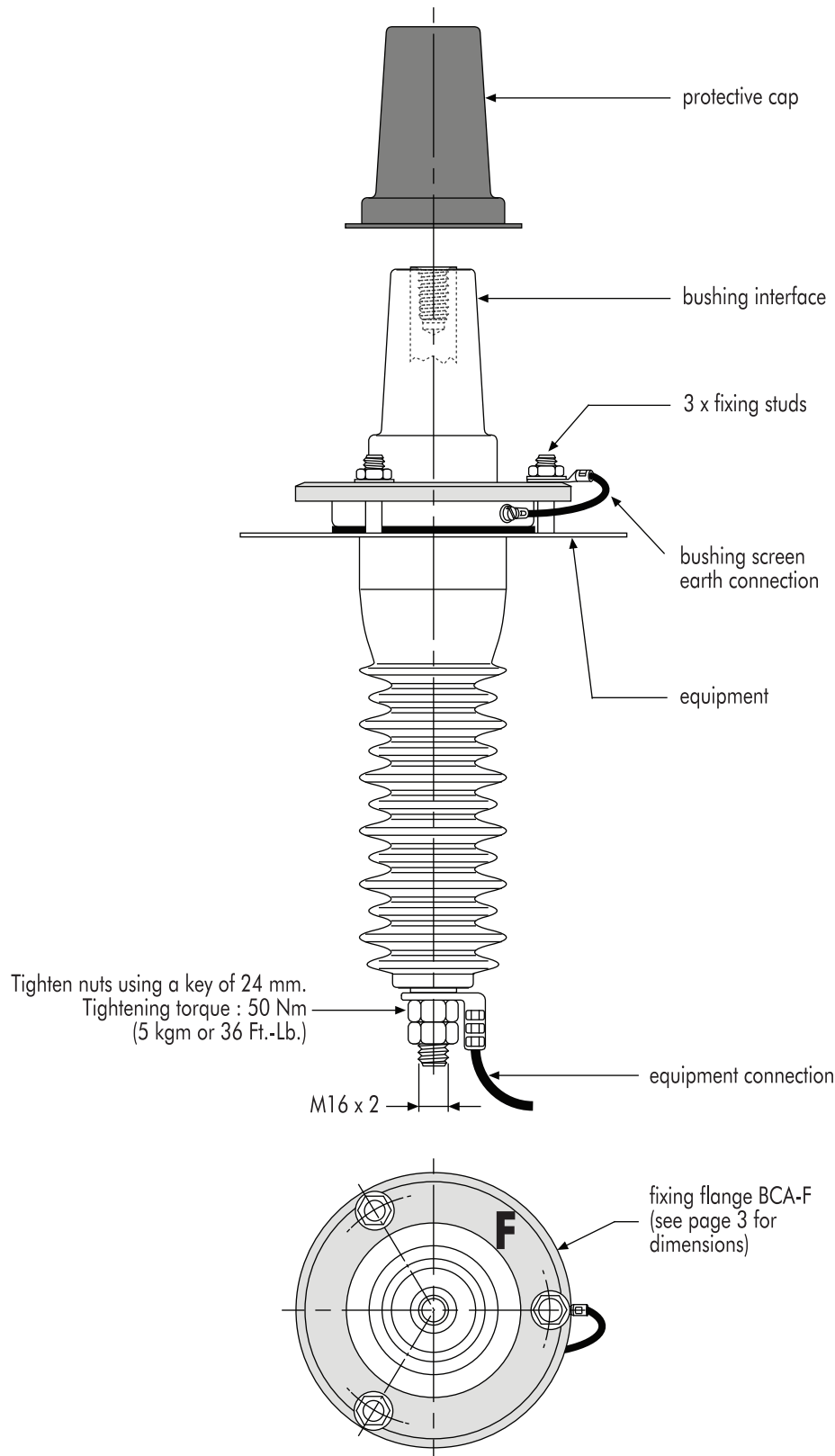

IMPORTANT NOTES :

- EUROMOLD bushings are supplied with protective caps over the mating interface offering protection against mechanical damage and the ingress of any contaminant. Under no circumstances should this shipping cap be considered as an electrical dead-ending device.
- EUROMOLD bushings should never be energised in isolation neither should they be disconnected whilst energised. They should always be connected to one of the recommended mating parts or the electrical dead ending device : K400DR-B or K400DR-B/G.
- Do not paint the interface.



FOR INFORMATION ONLY Please always use the instructions supplied in the kit



Fixing flange dimensions

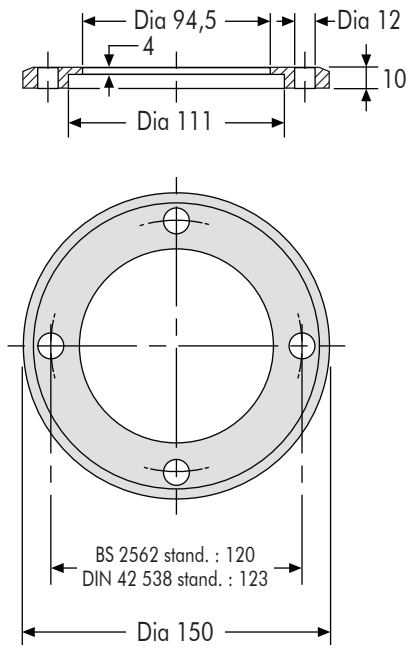

Type BCA-B : BS 2562 British standards
Type BCA-D : DIN 42 538 German standards

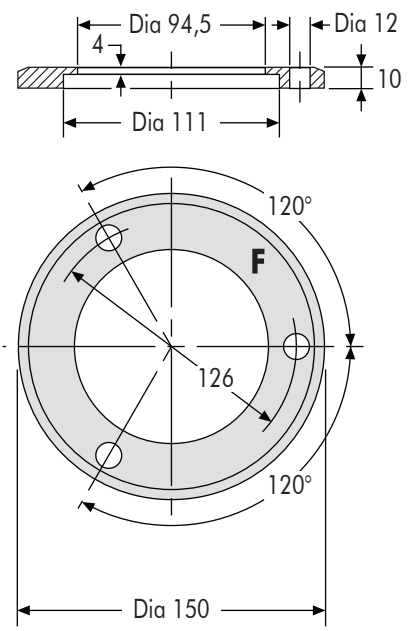

Type BCA-F : NFC 52-053 French standards

Equipment fixing dimensions

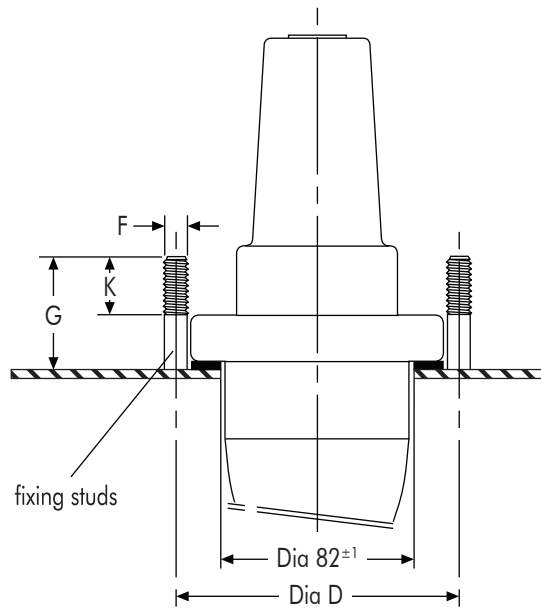

	Dia D (mm)	F (mm)	G (mm)	K (mm)	Fixing studs
DIN 42 538 (German standards)	123	M10	55	25	4
NFC 52-053 (French standards)	126	M8 or M10	52	27	3
BS 2562 (British standards)	120	-	-	-	4

FOR INFORMATION ONLY Please always use the instructions supplied in the kit